

*Quality Superior. Reliable.*

**MEXOR**

**PRODUCT CATALOGUE**

**NON-TOXIC**

**BENDABLE**

**LONG SERVICE LIFE**

**EXCELLENT HYDRAULICS**

**NON-CORROSIVE**





International  
Standards  
Certification  
Pty Ltd.

# TABLE OF CONTENTS

DESCRIPTION		PAGE NO.	
<b>COMPANY PROFILE</b>	<i>Brief Company History, About Us, Mission</i>	<b>4</b>	
<b>Pictures of Past Projects</b>		<b>6</b>	
<b>NEXOR HDPE Butt Fusion Pipes</b>	<i>For Potable Water System</i>	<b>8</b>	
<b>NEXOR Coiled HDPE Pipes for Service Connections</b>	<i>For Potable Water System</i>	<b>10</b>	
<b>NEXOR PE 100 Electro Fusion &amp; Injection Moulded Fittings</b>		<b>11</b>	
<b>NEXOR PP Push Fit Compression Fittings</b>	<i>The easiest way to connect pipes</i>	<b>12</b>	
<b>NEXOR HDPE Spigot Fittings</b>	<i>HDPE Fittings for Buttwelding</i>		
<ul style="list-style-type: none"> <li>● NEXOR Equal Tee (Segmented)</li> </ul>		<b>14</b>	
<ul style="list-style-type: none"> <li>● NEXOR Equal Tee (Moulded)</li> </ul>		<b>15</b>	
<ul style="list-style-type: none"> <li>● NEXOR Tee Reducer (Moulded)</li> </ul>		<b>15</b>	
<ul style="list-style-type: none"> <li>● NEXOR Concentric Reducer</li> </ul>		<b>16</b>	
<ul style="list-style-type: none"> <li>● NEXOR Eccentric Reducer</li> </ul>		<b>16</b>	
<ul style="list-style-type: none"> <li>● NEXOR Eccentric Reducer (Long version)</li> </ul>		<b>17</b>	
<ul style="list-style-type: none"> <li>● NEXOR HDPE Stubend</li> </ul>		<b>18</b>	
<b>NEXOR Galvanized Flange</b>			
<ul style="list-style-type: none"> <li>● NEXOR Flange or Blind Flange (ANSI B16.5 Class 150)</li> </ul>			<b>19</b>
<ul style="list-style-type: none"> <li>● NEXOR Flange or Blind Flange (DIN 10)</li> </ul>	<b>20</b>		
<ul style="list-style-type: none"> <li>● NEXOR Flange or Blind Flange (JIS 10)</li> </ul>	<b>21</b>		
<ul style="list-style-type: none"> <li>● NEXOR Flange or Blind Flange (ISO 7005-1 PN10/PN16)</li> </ul>	<b>22</b>		
<b>NEXOR HDPE End Cap</b>			<b>23</b>

# TABLE OF CONTENTS

	DESCRIPTION		PAGE NO.
	<b>NEXOR HDPE Segmented Elbow (30°, 60°, 90°)</b>		<b>25</b>
	<b>NEXOR HDPE Segmented Elbow (22.5°, 45°, 90°)</b>		<b>26</b>
	<b>NEXOR Standard G.I. Nipple</b>		<b>27</b>
	<b>NEXOR HDPE Pipes &amp; Fittings for Internal Plumbing</b>		<b>28</b>
	<ul style="list-style-type: none"> <li>● <b>NEXOR HDPE Straight Length Pipes</b></li> </ul>		<b>29</b>
	<ul style="list-style-type: none"> <li>● <b>NEXOR Socket Fusion Fittings</b></li> </ul>		<b>29</b>
	<ul style="list-style-type: none"> <li>● <b>NEXOR Brass Treaded Socket Fusion Fittings</b></li> </ul>		<b>30</b>
	<b>NEXOR Annular Corrugated Pipes</b>		<b>31</b>
	<b>NEXOR HDPE Pressure Mains Pipe</b>	<i>For Potable Water System</i>	<b>32</b>
	<b>Buttwelding Machine &amp; Tools</b>		<b>33</b>



## COMPANY PROFILE

### BRIEF COMPANY HISTORY

Junni Industries Inc. Is a corporate entity, duly registered on August 1, 2003, with the Securities and Exchange Commission under and in accordance with provisions of the Corporation Code of the Philippines with Securities and Exchange Commission (SEC) Registration No. CS200317177, with domicile address at 4th Floor NEXOR Bldg., 1677 Quezon Ave., West Triangle Q.C.

Technological innovations in the field of plastic piping technology and the unavailability of the use of such among pipe manufacturer in the Philippines motivated the start-up of the company.

Setting and maintaining a high quality standard of plastic products can be only possible through the use of the latest and modern manufacturing equipment. Junni Industries Inc. uses manufacturing equipment from the German company Krauss Maffei. Our technologically superior equipment guarantee superior product performance. In addition, our production lines are equipped with ultrasonic thickness measuring devices, melt filtration, and gravimetric dosing units.

Junni Industries Incorporated is affiliated with Cofta Mouldings Corporation – the pioneer and still the number one manufacturer of monoblock chairs, tables, drawers, PC twin wall roofing, PVC foam sheets, etc.

Junni Industries Inc. Introduced **NEXOR** brand of HDPE pipes. NEXOR brand stands for uncompromised high quality pipes and fittings made only from 100 % virgin Polyethylene resins. At Junni Industries Inc., we understand that in manufacturing pipes, the slightest dip in the thickness tolerance of the pipe defines the weakest point of the entire piping system. A pipe is as good as its weakest point or its thinnest wall section.





## ABOUT US



Pipe failure goes beyond the cost of simply replacing the pipe. In most applications, the short-sighted savings incurred in using inferior pipe materials is negated by the high cost of repair and re-installation of pipes. In internal plumbing applications for instance, expensive earth movements and or building structure adjustments have to be done in order to repair faulty pipe systems. Failure of pipes in agricultural applications may suspend the delivery of plant nutrients leading to poor harvests. Undetected leakage due to pipe failure is perhaps the worst with using inferior pipe. Leakage in buried pipes imposes a high tax in terms of energy costs in pumping water.

In recognition of the fact that pipe failure goes beyond the cost of simply replacing the pipe, NEXOR brand of pipes was established to stand for quality pipes at reasonable prices.

We, the makers of NEXOR pipes, are committed to practicing the highest level of engineering standards and to providing superior customer support. Should you have product inquiries or requirements, feel free to contact us or you may visit our website at [www.nexorpipes.com](http://www.nexorpipes.com) for further information.

## MISSION

Junni Industries Inc. envisions becoming the authority in the manufacture, design, and installation of piping systems in the Philippines for applications including potable water, drainage, sewage, gas, and others through constant investment in piping technology, practicing the highest level of engineering standards, and providing superior customer support.



# PAST PROJECTS

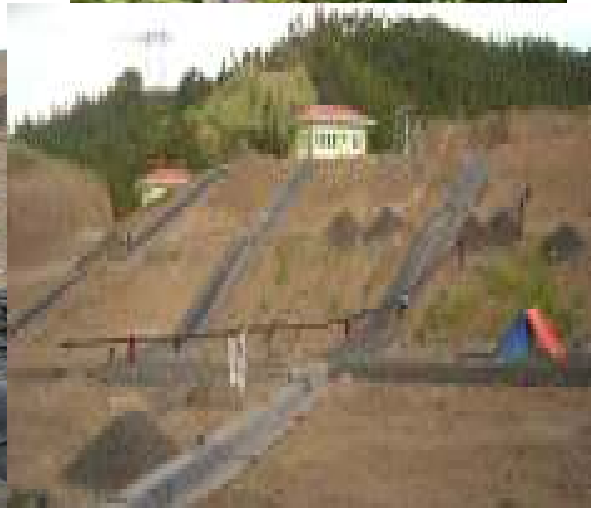



# NEXOR

## HDPE BUTT FUSION PIPES



- SPECIFICATION :
- PRODUCT PROPERTIES & FEATURES :
  - High Flow Capacity
  - Durable » Weather Resistance
  - » Chemical Resistance
  - Safe, easy to install and economical
- STANDARD COLOR : Black with blue stripes, Black or Blue
- INSTALLATION : Butt Fusion (equipment and electric generator required)
- NOTES : Difficult to install in challenging terrain, poor weather conditions

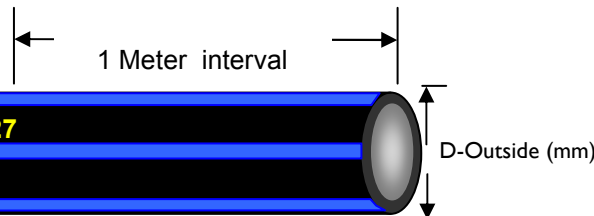

**NEXOR 63mm x 3.7mm PN16 PE100 " water " 08090807 ISO 4427**

		ACCORDING TO TIS. 982-2548				PE 100				Hydrostatic Design Stress is 8.0 MPa				
OD	PN4		PN 6.3		PN 8		PN10		PN 12.5		PN 16		PN20	
	SDR41		SDR 26		SDR 21		SDR 17		SDR 13.6		SDR 11		SDR 9	
	T	W	T	W	T	W	T	W	T	W	T	W	T	W
20											2.0	0.12	2.3	0.13
25									2.0	0.15	2.3	0.17	3.0	0.21
32							2.0	0.20	2.4	0.23	3.0	0.28	3.6	0.33
40					2.0	0.25	2.4	0.30	3.0	0.36	3.7	0.43	4.5	0.51
50			2.0	0.32	2.4	0.37	3.0	0.45	3.7	0.56	4.6	0.67	5.6	0.79
63			2.5	0.49	3.0	0.58	3.8	0.75	4.7	0.88	5.8	1.06	7.1	1.27
75			2.9	0.68	3.6	0.83	4.5	1.02	5.6	1.25	6.8	1.48	8.4	1.78
90			3.5	0.99	4.3	1.19	5.4	1.47	6.7	1.78	8.2	2.14	10.1	2.57
110			4.2	1.44	5.3	1.79	6.6	2.19	8.1	2.64	10.0	3.18	12.3	3.82
125			4.8	1.85	6.0	2.28	7.4	2.79	9.2	3.41	11.4	4.13	14.0	4.94
140			5.4	2.34	6.7	2.86	8.3	3.50	10.3	4.27	12.7	5.14	15.7	6.19
160			6.2	3.07	7.7	3.75	9.5	4.57	11.8	5.57	14.6	6.75	17.9	8.06
180			6.9	3.82	8.6	4.71	10.7	5.78	13.3	7.07	16.4	8.53	20.1	10.20
200			7.7	4.74	9.6	5.84	11.9	7.13	14.7	8.67	18.2	10.52	22.4	12.62
225			8.6	5.95	10.8	7.38	13.4	9.04	16.6	11.01	20.5	13.32	25.2	15.97
250			9.6	7.38	11.9	9.03	14.8	11.08	18.4	13.56	22.7	16.38	27.9	19.63
280			10.7	9.20	13.4	11.40	16.6	13.92	20.6	16.99	25.4	20.53	31.3	24.67
315	7.7	7.58	12.1	11.72	15.0	14.33	18.7	17.63	23.2	21.53	28.6	25.99	35.2	31.21
355	8.7	9.64	13.6	14.81	16.9	18.19	21.1	22.44	26.1	27.30	32.2	32.99	39.7	39.64
400	9.8	12.22	15.3	18.78	19.1	23.19	23.7	28.36	29.4	34.62	36.3	41.89	44.7	50.29
450	11.0	15.41	17.2	23.75	21.6	29.45	26.7	35.93	33.1	43.85	40.9	53.04	50.3	63.67
500	12.3	19.18	19.1	29.30	23.9	36.19	29.7	44.39	36.8	54.10	45.4	65.45	55.8	78.46
560	13.7	23.89	21.4	36.72	26.7	45.29	33.2	55.61	41.2	67.88	50.8	81.99		
630	15.4	30.22	24.1	46.53	30.0	57.21	37.4	70.43	46.3	85.80	57.2	103.88		
710	17.4	38.52	27.2	59.24	33.9	72.96	42.1	89.51	52.2	109.17				
800	19.6	48.84	30.6	75.03	38.1	92.48	47.4	113.5	58.8	138.48				
900	22.0	61.60	34.4	95.28	42.9	117.02	53.3	143.57						
1000	24.5	76.27	38.2	117.10	47.7	144.57	59.3	177.44						
1200	29.4	109.8	45.9	168.65	57.2	208.09								
1400	34.3	149.42	53.5	229.39	-									
1600	39.2	195.12	61.2	299.90	-									



## HDPE BUTT FUSION PIPES

### WELDED SEAM

Under actual site conditions, the size, shape and evenness of the welded seam can only be checked visually. Other methods of examination are based on samples cut from the seam and studied in a laboratory.

However a seam welded by following the instructions has been found to be reliable. The adjacent column shows some examples of welded seams.

Should the seam be unsatisfactory, it is cut off and the ends rewelded together again.

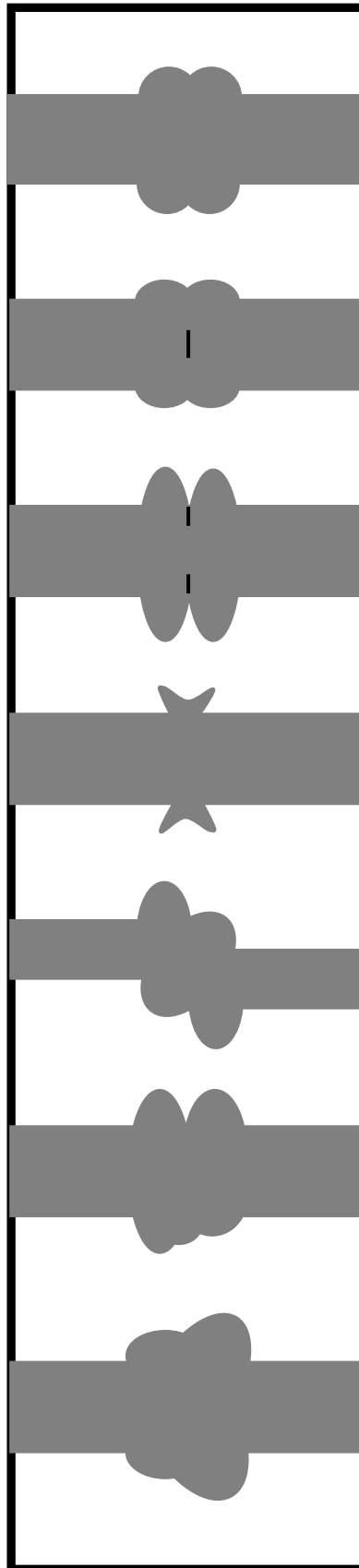
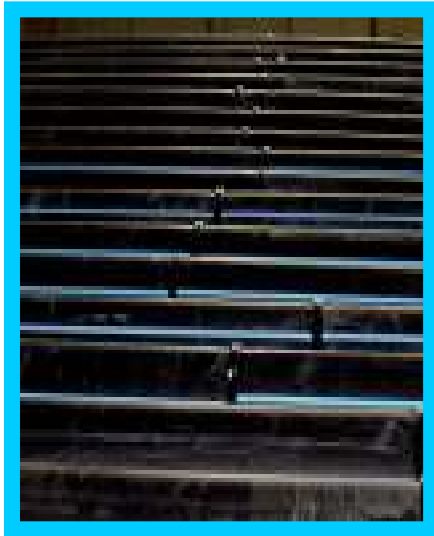

A good seam with a prominent, high bead.

The bead is too low ( not enough welding pressure ).

A deep split in the bead ( not enough heat, or transition time too long ).

The bead is too narrow and high ( too much pressure ).

Improper alignment. Max. permitted deviation is 10% of the wall thickness.

Different wall thickness. Bevelling the thicker one is recommended.

The welded materials have different melting temperatures/ heating times.



**COILED HDPE PIPES FOR SERVICE CONNECTIONS**

SDR 17				
Nominal Size	OD (mm)	Thk (mm)	Coil Length (m)	Weight (kgs.)
1/2"	20	1.6	150	14.1
1/2"	20	1.6	300	28.1
3/4"	25	1.6	150	17.9
1"	32	1.9	100	18.1
1 1/4"	40	2.4	60	17.0
1 1/2"	50	2.9	60	25.5
2"	63	3.7	60	41.7
2 1/2"	75	4.5	60	59.8
3"	90	5.4	60	85.5
4"	110	6.6	50	105.8

SDR 13.6				
Nominal Size	OD (mm)	Thk (mm)	Coil Length (m)	Weight (kgs.)
1/2"	20	1.6	150	14.1
1/2"	20	1.6	300	28.1
3/4"	25	1.8	150	19.9
1"	32	2.4	100	22.2
1 1/4"	40	3.0	60	20.7
1 1/2"	50	3.7	60	32.5
2"	63	4.7	60	51.5
2 1/2"	75	5.6	60	72.6
3"	90	6.7	60	105.10
4"	110	8.1	50	128.70

SDR 11				
Nominal Size	OD (mm)	Thk (mm)	Coil Length (m)	Weight (kgs.)
1/2"	20	1.8	100	10.4
1/2"	20	1.8	150	15.6
1/2"	20	1.8	300	31.1
3/4"	25	2.3	100	16.4
3/4"	25	2.3	150	24.5
1"	32	3.0	100	27.0
1 1/4"	40	3.7	60	25.5
1 1/2"	50	4.6	60	39.3
2"	63	5.8	60	61.9
2 1/2"	75	6.8	60	87.2
3"	90	8.2	60	125.40
4"	110	10.0	50	154.9



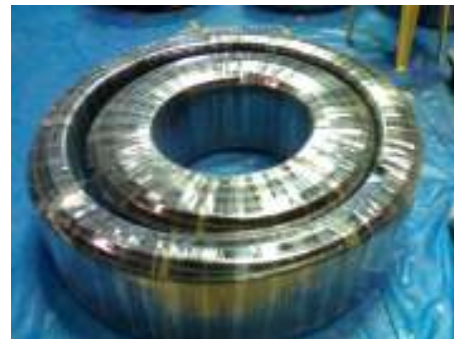

SDR 9				
Nominal Size	OD (mm)	Thk (mm)	Coil Length (m)	Weight (kgs.)
1/2"	20	2.3	150	19.1
1/2"	20	2.3	300	38.2
3/4"	25	2.8	150	29.0
1"	32	3.6	100	32.3
1 1/4"	40	4.5	60	30.0
1 1/2"	50	5.6	60	46.4
2"	63	7.1	60	74.5
2 1/2"	75	8.4	60	104.4
3"	90	10.1	60	151.1
4"	110	12.3	50	186.3

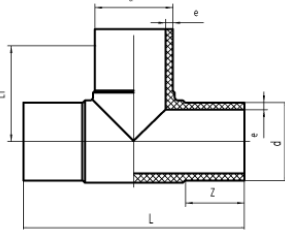

### ELECTROFUSION

	COUPLER	ELBOW 45	ELBOW 90	EQUAL TEE	REDUCING COUPLER	REDUCING TEE
						
Sizes Available	32 to 315	63 to 160	32 to 160	32 to 160	40x32, 50x32, 50x40, 63x32, 63x40, 63x50, 90x63, 110x63, 110x90, 160x90, 160x110	40x32, 50x32, 50x40, 63x32, 63x40, 63x50, 90x63, 110x63, 110x90, 160x90, 160x110

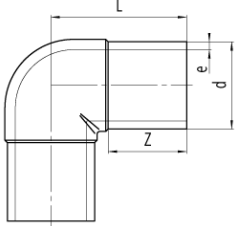
### INJECTION MOULDED

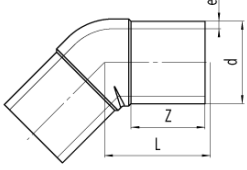
	EQUAL TEE	90° ELBOW	45° ELBOW
	 	 	 
Sizes Available	63 to 315	63 to 160	63 to 160

Description	Male Tee	Price	Female Tee	Price	Equal Elbow	Price
20mm x 1/2"		55.00		57.00		49.00
25mm x 3/4"		61.00		61.00		72.00
32mm x 1"		99.00		99.00		100.00
40mm x 1 1/4"		238.00		200.00		233.00
50mm 1 1/2"		349.00		328.00		313.00
63mm x 2"		427.00		470.00		404.00
75mm x 2 1/2"		1,086.00		1,038.00		990.00
90mm x 3"		2,328.00		2,387.00		1,838.00
110mm x 4"		2,642.00		2,769.00		2,391.00

Description	Male Elbow	Price	Female Elbow	Price	End Cap	Price
20mm x 1/2"		35.00		36.00		23.00
25mm x 3/4"		48.00		50.00		28.00
32mm x 1"		63.00		75.00		40.00
40mm x 1 1/4"		147.00		150.00		124.00
50mm 1 1/2"		208.00		216.00		172.00
63mm x 2"		333.00		333.00		188.00
75mm x 2 1/2"		555.00		654.00		492.00
90mm x 3"		1,644.00		1,644.00		908.00
110mm x 4"						1,446.00

Tapping Ferrule	Description	Ferrule
	1 1/4" x 25mm	640.00
	1 1/4" x 32mm	640.00

## PP PUSH FIT COMPRESSION FITTINGS

NEXOR PP compression fittings are the easiest way to connect PE pipes. No equipment is necessary, just simply insert and twist to connect pipes. Twisting action compresses clinching ring which buries itself into the pipe for a secure fit.

Description	Male Threaded Adaptor	Price	Female Threaded Adaptor	Price	Straight Coupler	Price	Equal Tee	Price
20mm x 1/2"	 	27.00	 	27.00	 	50.00	 	69.00
25mm x 3/4"		37.00		41.00		64.00		93.00
32mm x 1"		53.00		62.00		76.00		126.00
40mm x 1 1/4"		124.00		97.00		185.00		360.00
50mm x 1 1/2"		151.00		181.00		239.00		435.00
63mm x 2"		222.00		312.00		393.00		578.00
75mm x 2 1/2"		466.00		528.00		816.00		1,426.00
90mm x 3"		908.00		1,255.00		1,275.00		2,535.00
110mm x 4"		1,261.00		1,693.00		3,932.00		3,411.00
Description	Reducing Coupler	Price	Reducing Tee	Price	Saddle Clamp			Price
25mm x 20mm	 	58.00	 	89.00	32mm x 1/2"	122.00	90mm x 3/4"	396.00
32mm x 20mm		87.00		115.00	32mm x 3/4"	122.00	90mm x 1"	396.00
32mm x 25mm		87.00		116.00	32mm x 1"	122.00	90mm x 1 1/4"	463.00
40mm x 20mm		151.00		-	40mm x 1/2"	128.00	90mm x 1 1/2"	413.00
40mm x 25mm		160.00		287.00	40mm x 3/4"	128.00	90mm x 2"	397.00
40mm x 32mm		173.00		342.00	40mm x 1"	128.00	110mm x 1/2"	439.00
50mm x 20mm		192.00		370.00	50mm x 1/2"	94.00	110mm x 3/4"	491.00
50mm x 25mm		195.00			50mm x 3/4"	124.00	110mm x 1"	491.00
50mm x 32mm		195.00		373.00	50mm x 1"	128.00	110mm x 1 1/4"	594.00
50mm x 40mm		222.00		373.00	63mm x 1/2"	138.00	110mm x 1 1/2"	541.00
63mm x 25mm		283.00			63mm x 3/4"	152.00	110mm x 2"	624.00
63mm x 32mm		263.00		635.00	63mm x 1"	152.00	160mm x 1/2"	733.00
63mm x 40mm		301.00		635.00	63mm x 1 1/4"	213.00	160mm x 3/4"	915.00
63mm x 50mm		337.00		635.00	75mm x 1/2"	293.00	160mm x 1"	915.00
75mm x 40mm		683.00		1,367.00	75mm x 3/4"	308.00	160mm x 1 1/4"	979.00
75mm x 50mm		598.00		1,367.00	75mm x 1"	306.00	160mm x 1 1/2"	985.00
75mm x 63mm		610.00		1,367.00	75mm x 1 1/4"	340.00	160mm x 2"	1,028.00
90mm x 63mm		1,208.00		1,441.00	75mm x 1 1/2"	352.00	225mm x 3/4"	2,323.00
90mm x 75mm		1,270.00		1,441.00	75mm x 2"	350.00	225mm x 1"	2,323.00
110mm x 90mm		2,138.00			90mm x 1/2"	348.00	225mm x 2"	2,323.00

NEXOR Spigot Fittings are HDPE fittings for butt welding. Injection moulded and fabricated types available.

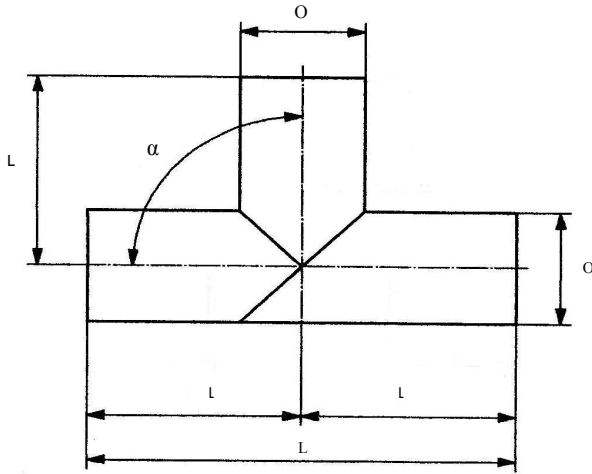

The pipes used for manufacturing these fittings shall be in accordance with ISO 4427-2, and the butt fusion machine shall be in accordance with ISO 12176-1.

**LEGEND:**

- OD    nominal outside diameter
- L     tubular length of fitting
- $L_i$    nominal lengths of fitting branch to axis
- $\alpha$    nominal angle of fitting (+ 2 $\sigma$ )

For tees fabricated out of pipe segments, the following derating rules for the calculation of the PN shall apply:

$$PN = f_T \times PN_{pipe}$$

where:

- $f_T$     = derating factor for tee having a value of 0.5
- $PN_{pipe}$  = nominal pipe pressure

**I. Material:**

a.) Base Compound:

- Material designation : HDPE
- Minimum Required Strength (MRS): 10 MPa at 50 years and 20°C
- Maximum allowable hydrostatic design stress: 8 MPa

b.) Extrusion Compound Properties:

- Melt Flow Rate (MFR): - shall range from 0.2g/10min to 1.3g/10min
- Minimum Density: 0.95 g/ml
- Minimum Tensile Strength at Break : 34 MPa
- Minimum Elongation at Break: 350%

II. Prior to acceptance and delivery, fittings and gasket shall pass the required test as PNS specifications.

Equal Tee 90 degrees (Segmented)		
OD	L	$L_i$
90	430	215
110	670	335
125	686	343
160	720	360
200	800	400
225	826	413
250	850	425
315	916	458
355	1156	578
400	1200	600
450	1750	875
500	1800	900
560	1860	930
630	1930	965
710	2610	1305
800	2700	1350
900	2800	1400
1000	3000	1500

## SPIGOT FITTINGS

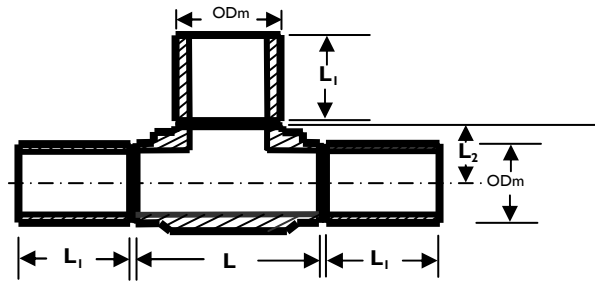

**LEGEND:**

- ODm = Outside diameter main
- ODb = Outside diameter branch
- L = Length moulded block
- L<sub>1</sub> = Length of pipe
- L<sub>2</sub> = Radius of moulded block

### NEXOR EQUAL TEE 90° (Moulded)

MAIN	L	L <sub>1</sub>	L <sub>2</sub>	MAIN	L	L <sub>1</sub>	L <sub>2</sub>
90	130	107.5	65	400	440	289	220
110	150	167.5	75	450	490	437.5	245
125	165	171.5	82.5	500	540	450	270
160	200	180	100	560	600	465	300
200	240	200	120	630	670	482.5	335
225	265	206.5	132.5	710	750	652.5	375
250	290	212.5	145	800	840	675	420
315	355	220	177.5	900	940	700	470
355	395	229	197.5	1000	1040	750	520

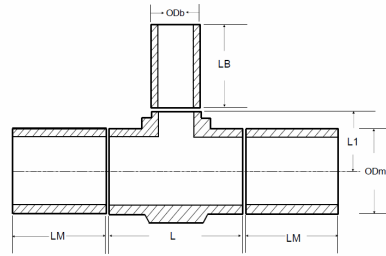

**LEGEND:**

- ODm = Outside diameter main
- ODb = Outside diameter branch
- L = Length moulded block
- LM = Length main pipe
- LB = Length of reduced pipe
- L<sub>1</sub> = Radius of moulded block

### NEXOR TEE REDUCER 90° (Moulded)

MAIN	BRANCH	L	LM	LB	L <sub>2</sub>	MAIN	BRANCH	L	LM	LB	L <sub>2</sub>	MAIN	BRANCH	L	LM	LB	L <sub>2</sub>
110	63	103	167.5	107.5	75	355	250	290	229	212.2	197.5	500	315	355	450	220	270
110	90	130	167.5	107.5	75	355	280	320	229		197.5	500	355	395	450	229	270
160	90	130	180	107.5	100	355	315	355	229	220	197.5	500	400	440	450	289	270
160	110	150	180	167.5	100	400	225	265	289	206.5	220	500	450	490	450	437.5	270
225	110	150	206.5	167.5	132.5	400	250	290	289	212.5	220	560	280	320	465		300
225	160	200	206.5	180	132.5	400	280	320	289		220	560	315	355	465	220	300
250	160	200	212.5	180	145	400	315	355	289	220	220	560	355	395	465	229	300
250	225	265	212.5	206.5	145	400	355	395	289	229	220	560	400	440	465	289	300
280	160	200		180	160	450	225	265	437.5	206.5	245	560	450	490	465	437.5	300
280	225	265		206.5	160	450	250	290	437.5	212.5	245	560	500	540	465	450	300
280	250	290		212.5	160	450	280	320	437.5		245	630	315	355	482.5	220	335
315	160	200	220	180	177.5	450	315	355	437.5	220	245	630	355	395	482.5	229	335
315	225	265	220	206.5	177.5	450	355	395	437.5	229	245	630	400	440	482.5	289	335
315	250	290	220	212.5	177.5	450	400	440	437.5	289	245	630	450	490	482.5	437.5	335
315	280	320	220		177.5	500	250	290	450	212.5	270	630	500	540	482.5	450	335
355	160	200	229	180	197.5	500	280	320	450		270	630	560	600	482.5	465	335
355	225	265	229	206.5	197.5												

Note: All dimensions are in mm.

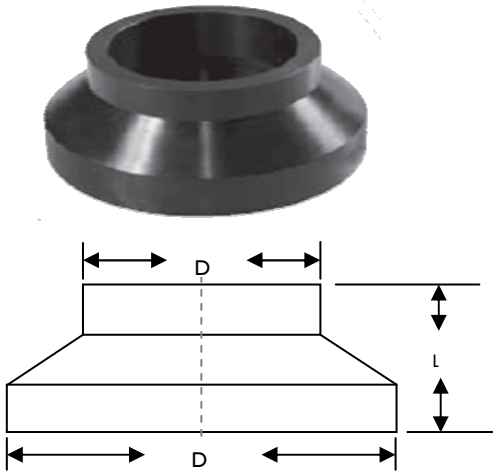

**LEGEND:**

- D<sub>1</sub> Outside diameter main pipe
- D<sub>2</sub> Outside diameter reduced pipe
- L Length of reducer

All units of measurements are in mm.

NEXOR CONCENTRIC REDUCER								
D <sub>1</sub>	D <sub>2</sub>	L	D <sub>1</sub>	D <sub>2</sub>	L	D <sub>1</sub>	D <sub>2</sub>	L
25	20	20	160	125	65	400	315	145
32	20	20	200	160	85	400	355	145
32	25	20	225	160	95	450	315	155
40	32	25	225	200	95	450	355	155
50	25	30	250	200	105	450	400	155
50	32	30	250	225	105	500	400	160
50	40	30	280	200	115	500	450	160
63	32	45	280	225	115	560	450	160
63	50	45	280	250	115	560	500	160
75	63	45	315	225	125	630	500	160
90	50	45	315	250	125	630	560	160
90	75	45	315	280	125	710	560	170
110	63	50	355	250	135	710	630	170
110	90	50	355	280	135	800	710	170
125	110	50	355	315	135	900	800	170
160	110	65	400	280	145	1000	900	170

NEXOR HDPE ECCENTRIC REDUCER			
D x D <sub>1</sub>	L	D x D <sub>1</sub>	L
32 x 20	50	225 x 200	165
32 x 25	50	250 x 200	175
40 x 25	55	250 x 225	175
40 x 32	55	280 x 225	185
50 x 32	65	280 x 250	185
50 x 40	65	315 x 250	195
63 x 40	75	315 x 280	195
63 x 50	75	355 x 280	205
75 x 50	85	355 x 315	205
75 x 63	85	400 x 315	215
90 x 63	95	400 x 355	215
90 x 75	95	450 x 355	225
110 x 75	105	450 x 400	225
110 x 90	105	500 x 400	235
125 x 90	115	500 x 450	235
125 x 110	115	560 x 450	235
160 x 125	135	560 x 500	235
200 x 160	155	630 x 500	235
		630 x 560	235

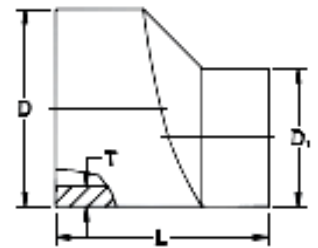

**LEGEND:**

- D Outside diameter main pipe
- D<sub>1</sub> Outside diameter reduced pipe
- L Length of reducer
- T Refers to Standard Dimension Ratio (SDR)

All units of measurements are in mm.



## SPIGOT FITTINGS

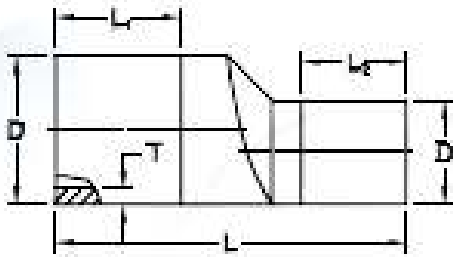

**LEGEND:**

- D Outside diameter main pipe
- D<sub>1</sub> Outside diameter reduced pipe
- L Length of reducer
- L<sub>1</sub> Length of main pipe
- L<sub>2</sub> Length of reduced pipe
- T Refers to Standard Dimension Ratio (SDR)

*All units of measurements are in mm.*

NEXOR HDPE ECCENTRIC REDUCER (Long Version)							
D x D <sub>1</sub>	L	L <sub>1</sub>	L <sub>2</sub>	D x D <sub>1</sub>	L	L <sub>1</sub>	L <sub>2</sub>
32 x 20	250	100	100	225 x 200	565	200	200
32 x 25	250	100	100	250 x 200	575	200	200
40 x 25	255	100	100	250 x 225	575	200	200
40 x 32	255	100	100	280 x 225	585	200	200
50 x 32	315	150	100	280 x 250	585	200	200
50 x 40	315	150	100	315 x 250	595	200	200
63 x 40	325	150	100	315 x 280	595	200	200
63 x 50	375	150	150	355 x 280	705	300	200
75 x 50	385	150	150	355 x 315	705	300	200
75 x 63	385	150	150	400 x 315	715	300	200
90 x 63	395	150	150	400 x 355	815	300	300
90 x 75	395	150	150	450 x 355	925	400	300
110 x 75	405	150	150	450 x 400	925	400	300
110 x 90	405	150	150	500 x 400	935	400	300
125 x 90	415	150	150	500 x 450	1035	400	400
125 x 110	415	150	150	560 x 450	1235	600	400
160 x 125	435	150	150	560 x 500	1235	600	400
200 x 160	505	200	150	630 x 500	1235	600	400
				630 x 560	1435	600	600

## MOULDED SPIGOT FITTINGS

**INSTALLATION** : Bolts and nuts.  
**STUB END MATERIAL** : Polyethylene  
**FLANGE MATERIAL** : Carbon Mild Steel A36

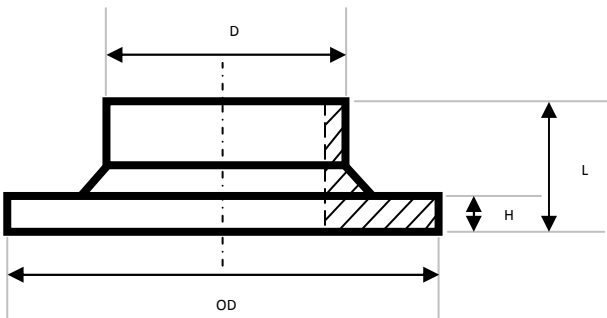

**LEGEND:**

- D Outside diameter main pipe
- OD Outside diameter of stub end
- L Length of stub end
- H Height of stubend

All units of measurements are in mm.

HDPE STUB END DIN 16963					
D	OD	H	L	Suitable up to SDR	
20	45	10	75	9	
25	54	10	75		
32	63	10	75		
40	73	11	75		
50	82	12	75		
63	100	14	35		
75	118	16	35		
90	130	17	40		
110	155	18	45		
125	155	25	45		
160	212	25	65		
180	212	30	65		
200	265	32	75		
225	265	32	75		
250	320	35	90		
280	320	35	90		
315	370	35	95		
355	415	40	95		
400	480	46	95		
450 (ANSI/ISO)	530	60	120	11	
450 (DIN/JIS)	580	60	120		
500	585	60	120		
560 (ANSI)	640	60	120		
560 (DIN/JIS/ISO)	685	60	120		
630	685	60	120		
710	800	60	120		
800	905	60	120		
900	1005	60	120		13.6
1000 (ANSI)	1080	60	120		17
1000 (DIN/JIS/ISO)	1110	60	120		
1200	1330	60	130	21	
1400	1490	70	140	26	
1600	1720	90	170		

**NOTE: STUB END WITH WELDED PIPE EXTENSION ARE SUBJECT TO PIPE AVAILABILITY**

## STUB FLANGE—SPIGOT FITTINGS

### Galvanized Flange

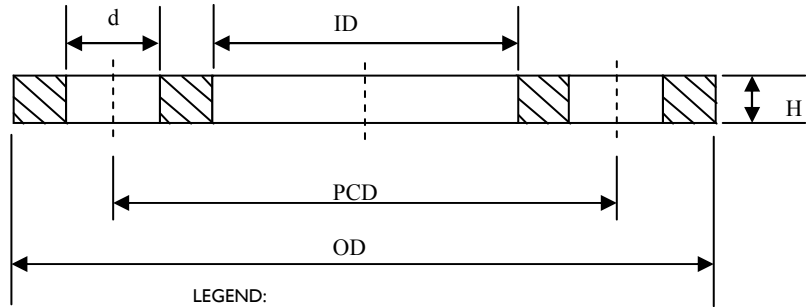

LEGEND:

- OD outside diameter
- ID inside diameter
- H height of flange
- d diameter for bolts & nuts
- PCD parallel distance between bolts

FLANGE OR BLIND FLANGE					BOLT HOLES		
ANSI B16.5-1996 CLASS 150					ANSI STANDARD		
Pipe Size	OD	ID	PCD	H	d	thread size	number
20	90	32	60.5	6	16	1/2"	4
25	98	37	70	8	16	1/2"	4
32	108	44	79.5	8	16	1/2"	4
40	117	52	89	8	16	1/2"	4
50	127	62	98.5	10	16	1/2"	4
63	152	78	120.5	10	20	5/8"	4
75	178	92	139.5	10	20	5/8"	4
90	191	108	152	12	20	5/8"	4
110	229	128	190.5	12	20	5/8"	8
125	254	140	216	16	23	3/4"	8
160	279	178	241	16	23	3/4"	8
180	279	195	241	16	23	3/4"	8
200	343	235	298.5	20	23	3/4"	8
225	343	240	298.5	20	23	3/4"	8
250	406	290	362	20	26	7/8"	12
280	406	300	362	20	26	7/8"	12
315	483	345	432	25	26	7/8"	12
355	535	376	476	28	29	1"	12
400	600	430	540	32	29	1"	16
450	635	480	578	36	32	1 1/8"	16
500	700	533	635	40	32	1 1/8"	20
630	813	660	749	50	35	1 1/4"	20
710	927	745	863.5	71	35	1 1/4"	28
800	1060	835	978	81	41	1 1/2"	28
900							
1000	1290	1030	1124	90	41	1 1/2"	36
1200	1510	1235	1422.5	108	41	1 1/2"	44
1400	1683	1440	1594	120	48	1 3/4"	44
1600							

Note: All dimensions are in mm.



## STUB FLANGE—SPIGOT FITTINGS

FLANGE OR BLIND FLANGE					BOLT HOLES		
DIN 10					DIN STANDARD		
Pipe Size	OD	ID	PCD	H	d	thread size	number
20	95	31	65	14	14	M12	4
25	105	36	70	16	14	M12	4
32	115	43	85	16	14	M12	4
40	140	53	100	16	18	M16	4
50	150	64	110	16	18	M16	4
63	165	78	125	16	18	M16	4
75	185	91	145	18	18	M16	4
90	200	108	160	18	18	M16	8
110	220	128	180	20	18	M16	8
125	220	135	180	20	18	M16	8
160	285	178	240	22	22	M20	8
180	285	188	240	22	22	M20	8
200	340	235	295	24	22	M20	8
225	340	238	295	24	22	M20	8
250	395	288	350	26	22	M20	12
280	395	294	350	26	22	M20	12
315	445	338	400	26	22	M20	12
355	505	376	460	26	22	M20	16
400	565	430	515	26	26	M24	16
450	670	517	620	28	26	M24	20
500	670	533	620	28	26	M24	20
560	780	618	725	34	30	M27	20
630	780	645	725	34	30	M27	24
710	895	740	840	38	30	M27	24
800	1015	843	950	42	33	M30	24
900	1115	947	1050	46	33	M30	28
1000	1230	1043	1160	52	36	M33	28
1200	1455	1233	1380	60	39	M36	32
1400							
1600							

Note: All dimensions are in mm.



**STUB FLANGE—SPIGOT FITTINGS**

FLANGE OR BLIND FLANGE					BOLT HOLES		
JIS 10					JIS STANDARD		
Pipe Size	OD	ID	PCD	H	d	thread size	number
20	95	31	70	12	15	M12	4
25	100	36	75	14	15	M12	4
32	125	43	90	14	19	M16	4
40	135	53	100	16	19	M16	4
50	140	64	105	16	19	M16	4
63	155	78	120	16	19	M16	4
75	175	91	140	18	19	M16	4
90	185	108	150	18	19	M16	8
110	210	128	175	18	19	M16	8
125	210	135	175	18	19	M16	8
160	280	178	240	22	23	M20	8
180	280	188	240	22	23	M20	8
200	330	235	290	22	23	M20	12
225	330	238	290	22	23	M20	12
250	400	288	355	24	25	M22	12
280	400	294	355	24	25	M22	12
315	445	338	400	24	25	M22	16
355	490	376	445	26	25	M22	16
400	560	430	510	28	27	M24	16
450	675	517	620	30	27	M24	20
500	675	533	620	30	27	M24	20
560	795	618	730	32	33	M30	24
630	795	645	730	32	33	M30	24
710	905	740	840	34	33	M30	24
800	1020	843	950	36	33	M30	28
900	1120	947	1050	38	33	M30	28
1000	1235	1043	1160	40	39	M36	28
1200	1465	1233	1380	44	39	M36	32
1400	1630	1435	1540	48	46	M42	36
1600	1863	1635	1768	52	46	M42	44

**Note: All dimensions are in mm.**



## STUB FLANGE—SPIGOT FITTINGS

FLANGE OR BLIND FLANGE					BOLT HOLES		
ISO 7005-1 PN 10					ISO STANDARD		
Pipe Size	OD	ID	PCD	H	d	thread size	number
20	95	28	65	14	14	M12	4
25	105	34	75	16	14	M12	4
32	115	42	85	16	14	M12	4
40	140	51	100	18	18	M16	4
50	150	62	110	18	18	M16	4
63	165	78	125	20	18	M16	4
75	185	92	145	20	18	M16	8
90	200	108	160	20	18	M16	8
110	220	128	180	22	18	M16	8
125	220	135	180	22	18	M16	8
160	285	178	240	24	22	M20	8
180	285	188	240	24	22	M20	8
200	340	235	295	24	22	M20	8
225	340	238	295	24	22	M20	8
250	395	288	350	26	22	M20	12
280	395	294	350	26	22	M20	12
315	445	338	400	28	22	M20	12
355	505	376	460	30	22	M20	16
400	565	430	515	32	26	M24	16
450	615	470	565	35	26	M24	20
500	670	533	620	38	26	M24	20
560	780	618	725	42	29.5	M27	20
630	780	645	725	42	29.5	M27	20
710	895	740	840	50	29.5	M27	24
800	1015	843	950	50	32.5	M30	24
900	1115	947	1050	50	32.5	M30	28
1000	1230	1050	1160	50	35.5	M33	28
1200							
1400							
1600							

Note: All dimensions are in mm.



**STUB FLANGE—SPIGOT FITTINGS**

FLANGE OR BLIND FLANGE					BOLT HOLES		
ISO 7005-1 PN 16					ISO STANDARD		
Pipe Size	OD	ID	PCD	H	d	thread size	number
20	95	28	65	14	14	M12	4
25	105	34	75	16	14	M12	4
32	115	42	85	16	14	M12	4
40	140	51	100	18	18	M16	4
50	150	62	110	18	18	M16	4
63	165	78	125	20	18	M16	4
75	185	92	145	20	18	M16	8
90	200	108	160	20	18	M16	8
110	220	128	180	22	18	M16	8
125	220	135	180	22	18	M16	8
160	285	178	240	24	22	M20	8
180	285	188	240	24	22	M20	8
200	340	235	295	26	22	M20	12
225	340	238	295	26	22	M20	12
250	405	288	355	28	26	M24	12
280	405	294	355	28	26	M24	12
315	460	338	410	32	26	M24	12
355	520	376	470	35	30	M24	16
400	580	430	525	38	30	M27	16
450	640	470	585	42	30	M27	20
500	715	533	650	46	33	M30	20
560	840	618	770	52	36	M33	20
630	840	645	770	52	36	M33	20
710	910	740	840	60	36	M33	24
800	1025	843	950	60	39	M36	24
900	1125	947	1050	60	39	M36	28
1000	1255	1050	1170	60	42	M39	28
1200							
1400							
1600							

*Note: All dimensions are in mm.*

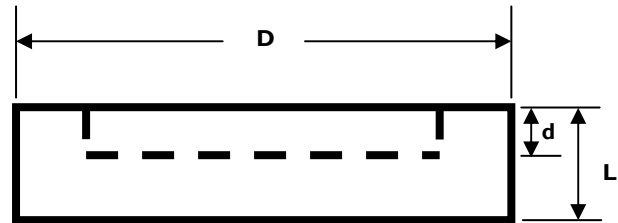

## LEGEND:

- D Outside diameter of pipe  
 d Depth of end cap  
 L Length of end cap

All units of measurements are in mm.

Used for non pressurized system.

HDPE End Cap		
D	L	d
20	32	10
25	32	10
32	32	10
40	32	10
50	32	10
63	32	10
75	32	10
90	32	10
110	32	10
125	32	10
160	32	10

## I. Material:

## a.) Base Compound:

- Material designation : HDPE
- Minimum Required Strength (MRS): 10 MPa at 50 years and 20°C
- Maximum allowable hydrostatic design stress: 8 MPa

## b.) Extrusion Compound Properties:

- Melt Flow Rate (MFR): - shall range from 0.2g/10min to 1.3g/10min
- Minimum Density: 0.95 g/ml
- Minimum Tensile Strength at Break : 34 MPa
- Minimum Elongation at Break: 350%

II. Prior to acceptance and delivery, fittings and gasket shall pass the required test as PNS specifications.



## SPIGOT FITTINGS



HDPE SEGMENTED ELBOW						
OD (mm)	30°		60°		90°	
	L (mm)	LI (mm)	L (mm)	LI (mm)	L (mm)	LI (mm)
63						
75						
90	182	0	182	135	182	135
110	295	0	295	139	295	139
125	297	0	297	144	297	144
160	302	0	302	152	302	152
200	327	0	327	194	327	194
225	330	0	330	201	330	201
250	334	0	334	206	334	206
280	338	0	338	223	338	223

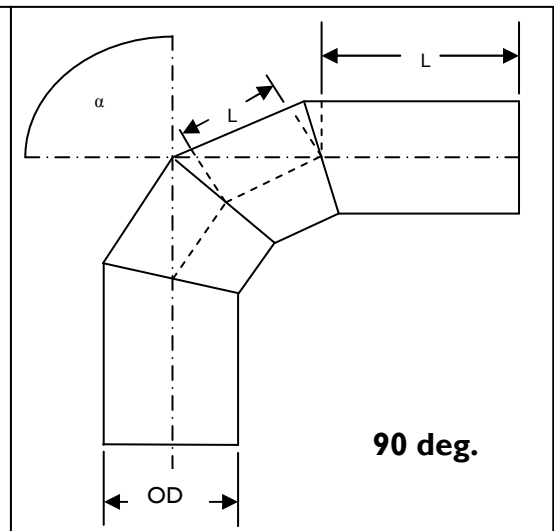
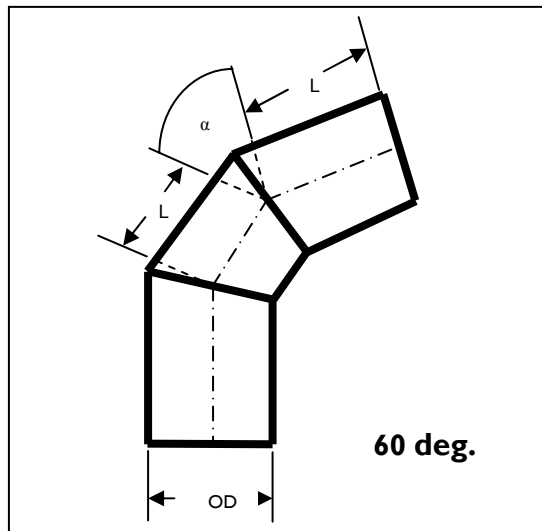
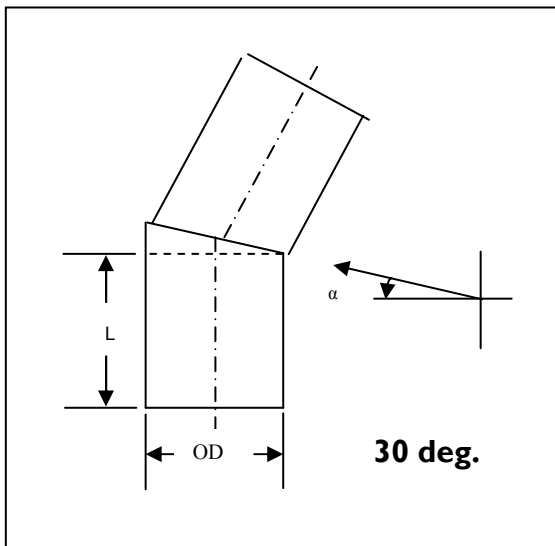

HDPE SEGMENTED ELBOW						
OD (mm)	22.5°		45°		90°	
	L (mm)	LI (mm)	L (mm)	LI (mm)	L (mm)	LI (mm)
355	448	n/a	448	279	448	279
400	454	n/a	454	314	454	314
450	711	n/a	711	353	711	353
500	718	n/a	718	393	718	393
560	726	n/a	726	440	726	440
630	735	n/a	735	495	735	495
710	1046	n/a	1046	557	1046	557
800	1058	n/a	1058	628	1058	628
900	1072	n/a	1072	707	1072	707
1000	1135	n/a	1135	785	1135	785

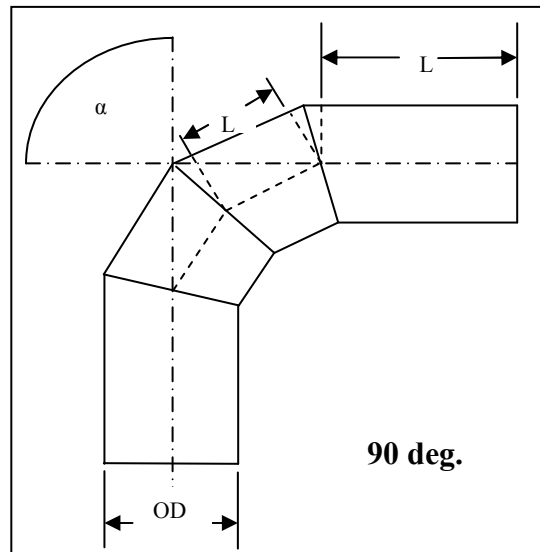
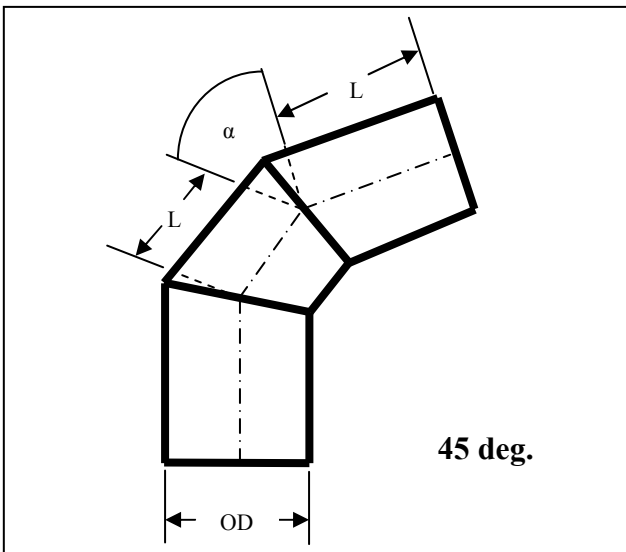
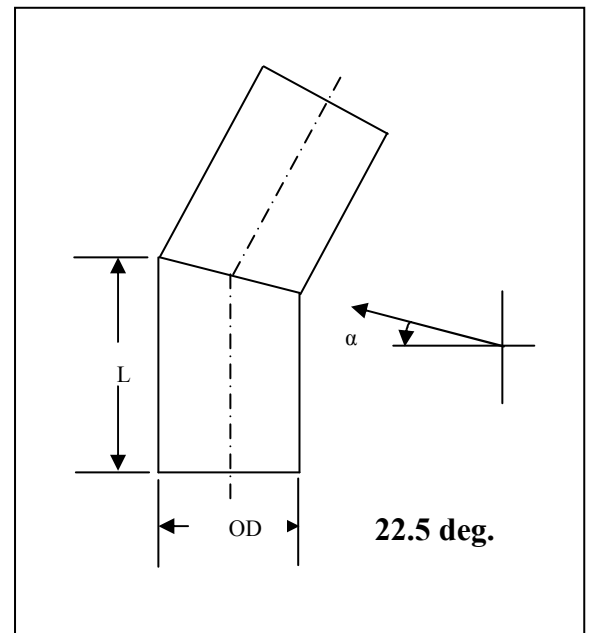

# STANDARD G.I. NIPPLE



**Product Features:**

**Material** : Schedule 40 (HD) Standard

**Thread** : ISO 7

**Packaging** : Threads with plastic wrap, packaged in boxes

TOTAL LENGTH		PRICE											
INCH	mm	1/2"	MIN. QTY.	3/4"	MIN. QTY.	1"	MIN. QTY.	1-1/4"	MIN. QTY.	1-1/2"	MIN. QTY.	2"	MIN. QTY.
close	31.75	9.47	500	12.63	400	18.83	300	26.54	200	30.31	200	N/A	
1 1/2	38.10	10.42	400	13.90	300	20.72	200	29.31	200	33.78	200	N/A	
2	50.80	12.41	400	16.55	300	24.66	200	35.11	200	41.03	100	46.89	100
2 1/2	63.50	14.31	300	19.08	300	28.41	200	40.63	100	47.94	100	55.17	80
3	76.20	16.31	300	21.75	200	32.38	200	46.48	90	55.24	80	63.91	70
3 1/2	88.90	18.38	300	24.50	200	36.47	200	52.50	80	62.77	70	72.93	60
4	101.60	20.39	200	27.19	200	40.46	100	58.37	70	70.10	60	81.72	50
4 1/2	114.30	22.32	200	29.77	200	44.29	100	64.00	70	77.14	60	90.15	50
5	127.00	24.33	200	32.44	200	48.26	90	69.84	60	84.44	50	98.90	50
5 1/2	139.70	26.28	200	35.05	200	52.13	80	75.54	60	91.57	50	107.44	40
6	152.40	28.66	200	38.22	200	56.84	80	82.47	50	100.23	40	117.81	40
7	177.80	32.47	200	43.29	100	64.38	70	93.57	50	114.11	40	134.44	30
8	203.20	36.50	200	48.66	90	72.35	60	105.31	40	128.78	40	152.01	30
9	228.60	40.36	100	53.82	80	80.00	50	116.57	40	142.86	30	168.88	30
10	254.00	45.28	90	60.38	70	89.74	50	130.91	40	160.78	30	190.35	30
12	304.80	51.76	80	69.01	60	102.56	40	149.77	30	184.36	30	218.60	20
14	355.60	60.66	70	80.88	50	120.18	40	175.71	30	216.79	20	257.45	20
16	406.40	68.71	60	91.61	50	136.13	30	199.18	30	246.12	20	292.59	20
18	457.20	79.45	60	105.93	40	157.39	30	230.48	20	285.24	20	339.45	20
20	508.00	86.28	50	115.04	40	170.92	30	250.39	20	310.13	20	369.27	20
22	558.80	94.48	50	125.97	40	187.15	30	274.29	20	340.00	20	405.06	10
24	609.60	104.50	40	139.33	30	206.99	20	303.49	20	376.51	20	448.79	10

## PIPES FOR INTERNAL PLUMBING

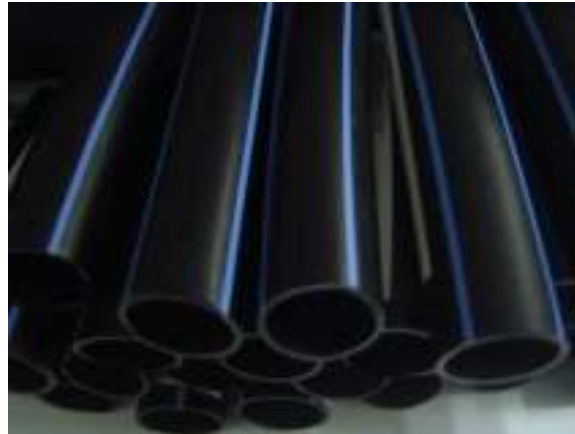

**PRODUCT  
INSTALLATION  
NOTES**

### STRAIGHT LENGTHS FOR INTERNAL PLUMBING

USE SOCKET FUSION FITTINGS  
NEED TO USE SOCKET FUSION WELDER

**LENGTH**

4 METERS

SDR Standard Dimension Ratio	Nominal Size	Outside Diameter (mm)	Inside Diameter (mm)	Thick- ness (mm)	Weight (kg)	Price
<b>13.6 Pressure Rating 128psi</b>	1/2"	20	16.8	1.6	0.4	-
	3/4"	25	21.4	1.8	0.5	82.60
	1"	32	27.2	2.4	0.9	140.50
	1 1/4"	40	34.0	3	1.4	219.50
	1 1/2"	50	42.6	3.7	2.1	338.80
	2"	63	53.6	4.7	3.4	541.90
	2 1/2"	75	63.8	5.6	4.8	768.60
	3"	90	76.6	6.7	6.9	1,103.80
<b>9 Pressure Rating 230psi</b>	1/2"	20	15.4	2.3	0.5	80.50
	3/4"	25	19.4	2.8	0.8	122.90
	1"	32	24.8	3.6	1.3	202.20
	1 1/4"	40	31.0	4.5	2.0	315.90
	1 1/2"	50	38.8	5.6	3.1	491.70
	2"	63	48.8	7.1	4.9	784.90
	2 1/2"	75	58.2	8.4	6.9	1,106.40
	3"	90	69.8	10.1	10.0	1,596.00
	4"	110	85.4	12.3	14.9	-

## PE SOCKET FUSION FITTINGS

NEXOR PE Socket fusion fittings are ideal for internal plumbing pipes. Socket fusion fittings are recommended for making straight length pipe connections. Socket fusion fittings and pipes are joined by simultaneously heating the external surface of the pipe and the internal surface of the fitting.

Size	Socket	Price	Elbow 90°	Price	Elbow 45°	Price
20mm		25.00		25.00		11.00
25mm		31.00		31.00		15.00
32mm		42.00		62.00		23.00
40mm		45.00		85.00		30.00
50mm		47.00		209.00		50.00
63mm		82.00		228.00		85.00
75mm		92.00		265.00		130.00
90mm		147.00		345.00		227.00
110mm		212.00		501.00		383.00
Size		Equal Tee		Price		End Cap
20mm		31.00		20.00		
25mm		36.00		25.00		
32mm		83.00		36.00		
40mm		98.00		45.00		
50mm		174.00		59.00		
63mm		188.00		64.00		
75mm		224.00		78.00		
90mm		372.00		150.00		
110mm		625.00		186.00		
Reducing Coupler	Size	Price	Size	Price	Size	Price
	25mm x 20mm	31.00	50mm x 40mm	46.00	90mm x 50mm	144.00
	32mm x 20mm	46.00	63mm x 32mm	69.00	90mm x 63mm	145.00
	32mm x 25mm	42.00	63mm x 40mm	52.00	90mm x 75mm	146.00
	40mm x 25mm	44.00	63mm x 50mm	65.00	110mm x 75mm	221.00
	40mm x 32mm	44.00	75mm x 50mm	91.00	110mm x 90mm	223.00
	50mm x 32mm	45.00	75mm x 63mm	95.00		
Reducing Tee	Size	Price	Size	Price	Size	Price
	25mm x 20mm	65.00	50mm x 40mm	125.00	90mm x 50mm	307.00
	32mm x 20mm	117.00	63mm x 32mm	-	90mm x 63mm	308.00
	32mm x 25mm	110.00	63mm x 40mm	131.00	90mm x 75mm	347.00
	40mm x 25mm	120.00	63mm x 50mm	134.00	110mm x 75mm	517.00
	40mm x 32mm	120.00	75mm x 50mm	163.00	110mm x 90mm	536.00
	50mm x 32mm	125.00	75mm x 63mm	192.00		



**BRASS THREADED PE SOCKET FUSION FITTINGS**

NEXOR Brass threaded PE Socket fusion fittings are ideal for internal plumbing pipes. Socket fusion fittings are recommended for making straight length pipe connections. Socket fusion fittings and pipes are joined by simultaneously heating the external surface of the pipe and the internal surface of the fitting.

Size	MTA	Price	FTA	Price	Male Elbow	Price
20mm		121.00		106.00		166.00
25mm		180.00		139.00		192.00
32mm		325.00		181.00		335.00
40mm		372.00		340.00		544.00
50mm		465.00		432.00		698.00
63mm		567.00		525.00		866.00
75mm		1,131.00		1,051.00		
90mm		2,892.00		2,827.00		
110mm		3,215.00		3,167.00		
Size		Female Elbow		Price		Male Union
20mm		121.00		257.00		219.00
25mm		142.00		315.00		286.00
32mm		297.00		472.00		431.00
40mm		458.00		676.00		606.00
50mm		663.00		1,101.00		881.00
63mm		824.00		1,573.00		1,223.00
Size	Male Tee	Price	Female Tee	Price		
20mm		172.00		127.00		
25mm		195.00		157.00		
32mm		346.00		215.00		
40mm		582.00		509.00		
50mm		737.00		711.00		
63mm		931.00		905.00		
PE SOCKET FUSION WELDER		SIZE		SIZE		
		63/20mm		110/75mm		
		PRICE		PRICE		
		Php 8,000.00		Php 40,600.00		



## ANNULAR CORRUGATED PIPES

### FOR DRAINAGE, SEWAGE, AND OTHER GRAVITY FLOW APPLICATIONS

- Economical, easy to use, flexible, impact resistant, corrosion free, UV resistant

#### •LOAD BEARING CAPACITY

1. Single Wall— Economical, ideal for foot traffic or light loads. (Golf courses, farms, landscaping)
2. Double Wall—Ideal for road side or highway drainage

#### •PERFORATED PIPES AVAILABLE

#### •SPLIT COUPLER JOINTS

SIZE (mm)	LENGTHS AVAILABLE			Single Wall	Double Wall
	30 mtrs	5.8 mtrs	11.5 mtrs.		
110 OD	√*	√	√	√	√
160 OD	√*	√	√	√	√
250 ID		√	√	√	√
300 ID		√	√	√	√
400 ID		√	√	√	√
500 ID		√	√	√	√
600 ID		√	√	√	√
800 ID		√	√	√	√

**NOTE: \*Single wall only.**



**HDPE PRESSURE MAINS—For Potable Water**

**NO NEED TO BUTTWELD HDPE PIPE**



- SPECIFICATION : PN 10
- PRODUCT PROPERTIES & FEATURES:
  - High Flow Capacity
  - Durable » Weather Resistance
  - » Chemical Resistance
  - Safe
  - Easy to install
  - Economical
- SIZES AVAILABLE : 63 mm Ø up to 225 mm Ø
- STANDARD COLOR : Black with blue stripes, Black or Blue
- INSTALLATION : Push Fit Type Connection. No equipment needed
- REPLACES : Class 150 uPVC Mains

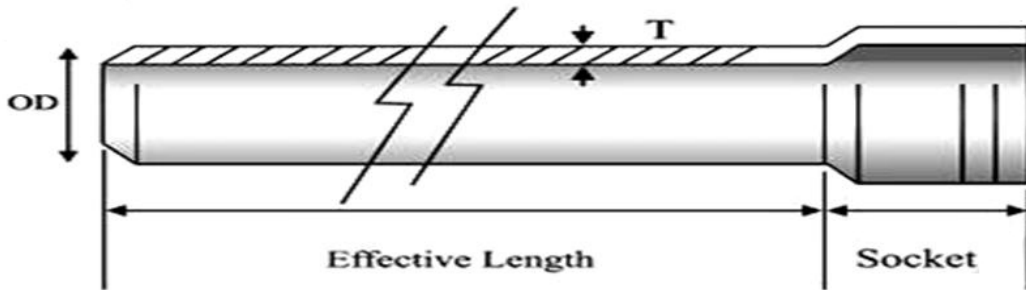

LEGEND:

- OD outside diameter
- T thickness of pipe
- EL effective length

All units of measurements are in mm.

OUTSIDE DIAMETER (mm)	6 METER LENGTHS			LONG LENGTHS		
	LENGTH (m)	PN 10 (150 PSI)		LENGTH (m)	PN 10 (150 PSI)	
		THICKNESS (mm)	PRICE		THICKNESS (mm)	PRICE
63	6	3.7	774.00	9 / 12	3.7	Available upon request
90	6	5.4	1,580.00		5.4	
110	6	6.6	2,360.00		6.6	
160	6	9.5	not yet		9.5	
225	6	13.4	available		13.4	





## BUTTWELDING MACHINE & TOOLS



QUALITY EQUIPMENT AND TOOLS FOR FUSION WELDING OF HDPE PIPES. PURCHASE OF BUTTFUSION MACHINE INCLUDES TRAINING AT NEXOR PIPES FACILITY IN ANTIPOLO FOR TWO PAX, INCLUSIVE OF SAMPLE PIPES FOR PRACTICE WELDING.

	SOCKET WELDER	MANUAL BUTTFUSION MACHINE	SEMI AUTOMATIC BUTTFUSION MACHINE W/ STUB END HOLDER
			
SIZE RANGE	20 to 63 75 to 110	50 to 160	<ol style="list-style-type: none"> <li>63 to 160</li> <li>90 to 250</li> <li>90 to 315</li> <li>225 to 450</li> <li>355 to 630</li> </ol>
ELECTRICAL REQUIREMENTS	220 V Single Phase	220 V Single Phase	<ol style="list-style-type: none"> <li>220 V Single Phase 5 KW</li> <li>220 V Single Phase 6 KW</li> <li>220 V Single Phase 7 KW</li> <li>400 V Three Phase 10 KW</li> <li>400 V Three Phase 15 KW</li> </ol>
SQUEEZE TOOL	PIPE CUTTER	BEAD REMOVER	ELECTROFUSION MACHINE
			
40 to 160 160 to 250	20 to 63 50 to 110 110 to 200	110 to 315	Input Voltage: 220 V Single Phase Output Voltage: 48 V Constant Voltage Constant Current Constant Power

**NEXOR BUTTFUSION MACHINE TECHNICAL SPECIFICATION**



	<b><u>160</u></b>	<b><u>315</u></b>	<b><u>450</u></b>	<b><u>630</u></b>	<b><u>800</u></b>	<b><u>1200</u></b>
Size Ranges (mm)	63-160	160 - 315	225 - 450	355 - 630	500 - 800	710 - 1200
Working Voltage	Single Phase 220 V 50 – 60 Hz	Single Phase 220 V 50 – 60 Hz	3 Phase 380/400 V 50 – 60 Hz	3 Phase 380/400 V 50 – 60 Hz	3 Phase 380/400 V 50 – 60 Hz	3 Phase 380/400 V 50 – 60 Hz
Total Power	5 KW	7 KW	10 KW	15 KW	20 KW	35 KW
Approx. Weight	120 KG.	250 KG.	600 KG.	800 KG.	1500 KG.	2800 KG.
Approx. Volume	0.7 CBM	1.2 CBM	3.5 CBM	5 CBM	10 CBM	20 CBM



**Plant Address:**

Sitio Rizza, Brgy. Pinugay, Antipolo City

**Office Address:**

4th Floor NEXOR Bldg., 1677 Quezon Ave., West Triangle, Quezon City

Phone: (02) 927-5441 • 386-8056 • 410-4288

TeleFax: (02) 415-0143

E-mail: [admin@nexorpipes.com](mailto:admin@nexorpipes.com)

Website: [www.nexorpipes.com](http://www.nexorpipes.com)